

Drop-in HEAVY-DUTY RAILING BRACKET SYSTEM

Instructions For Product No.
PR24V-DPIN, TPR-DPIN, PR24V-DPIN-CT AND TPR-DPIN-CT

1) Layout locations for brackets as shown in Fig. 1 (four holes for each bracket). The Drop In Adapter Jig will also help with the locations for the brackets.

2) Pre-drill four screw holes for each bracket using a 3/32" drill bit.

3) Fasten bracket to post using stainless steel screws that are provided.

4) Drop rail assembly into brackets and check to ensure all rail bottoms are against the brackets.

5) Pre-drill two screw holes for each side of the rail using a 3/32" drill bit. (Use 5/32" drill bit if using aluminum support)

6) Fasten rail assembly to brackets using stainless steel screws that are provided.

7.) Gently spread trim cover to fit over rail assembly as shown in Fig 2.

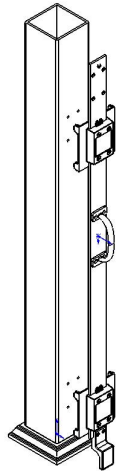
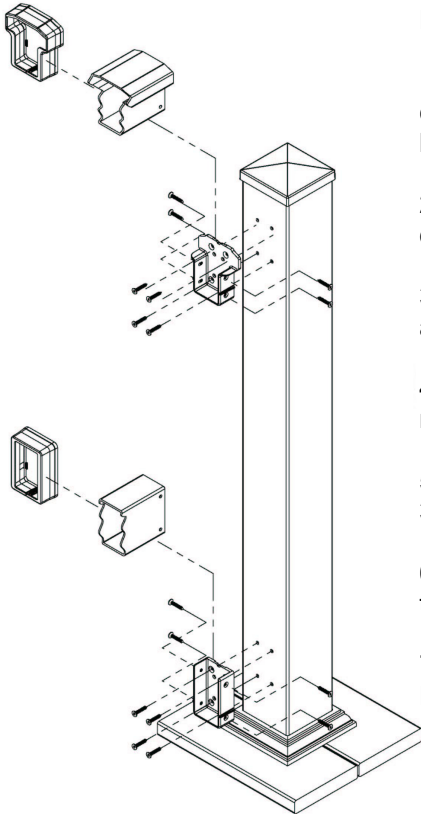

Drop In Adapter Jig Available

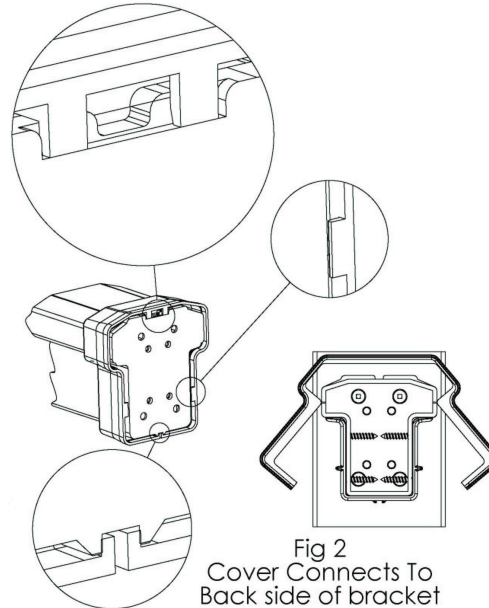
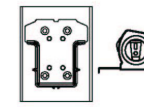
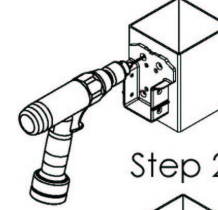

Fig 2
Cover Connects To
Back side of bracket



Step 1



Step 2

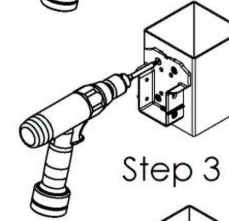

Step 3

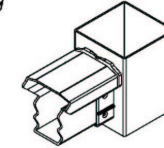

Step 4

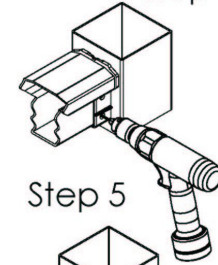

Step 5

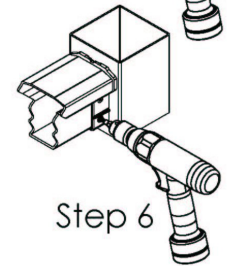

Step 6

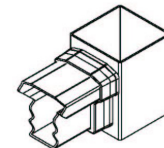

Step 7

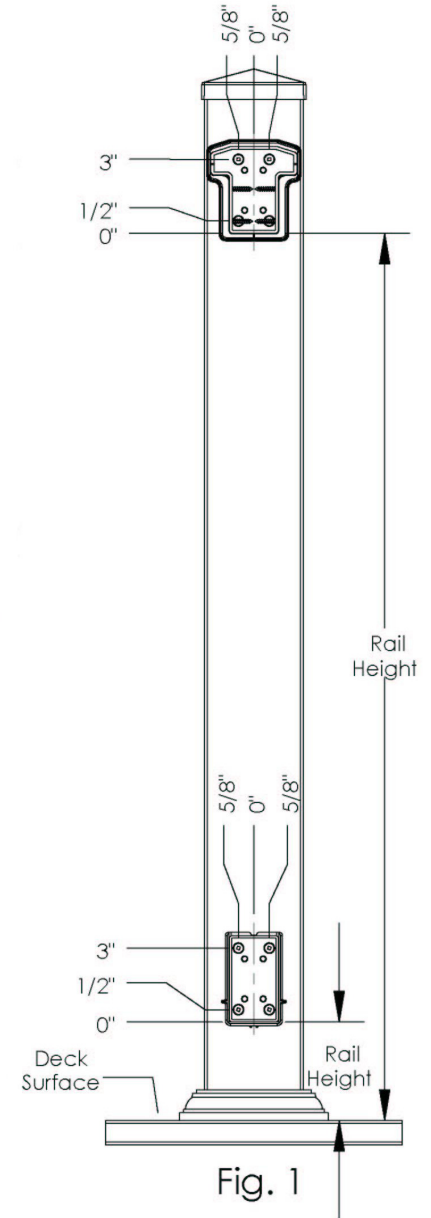

Fig. 1